

PARKING LOT LANDSCAPE EXHIBIT (SEC. 24-220(E))

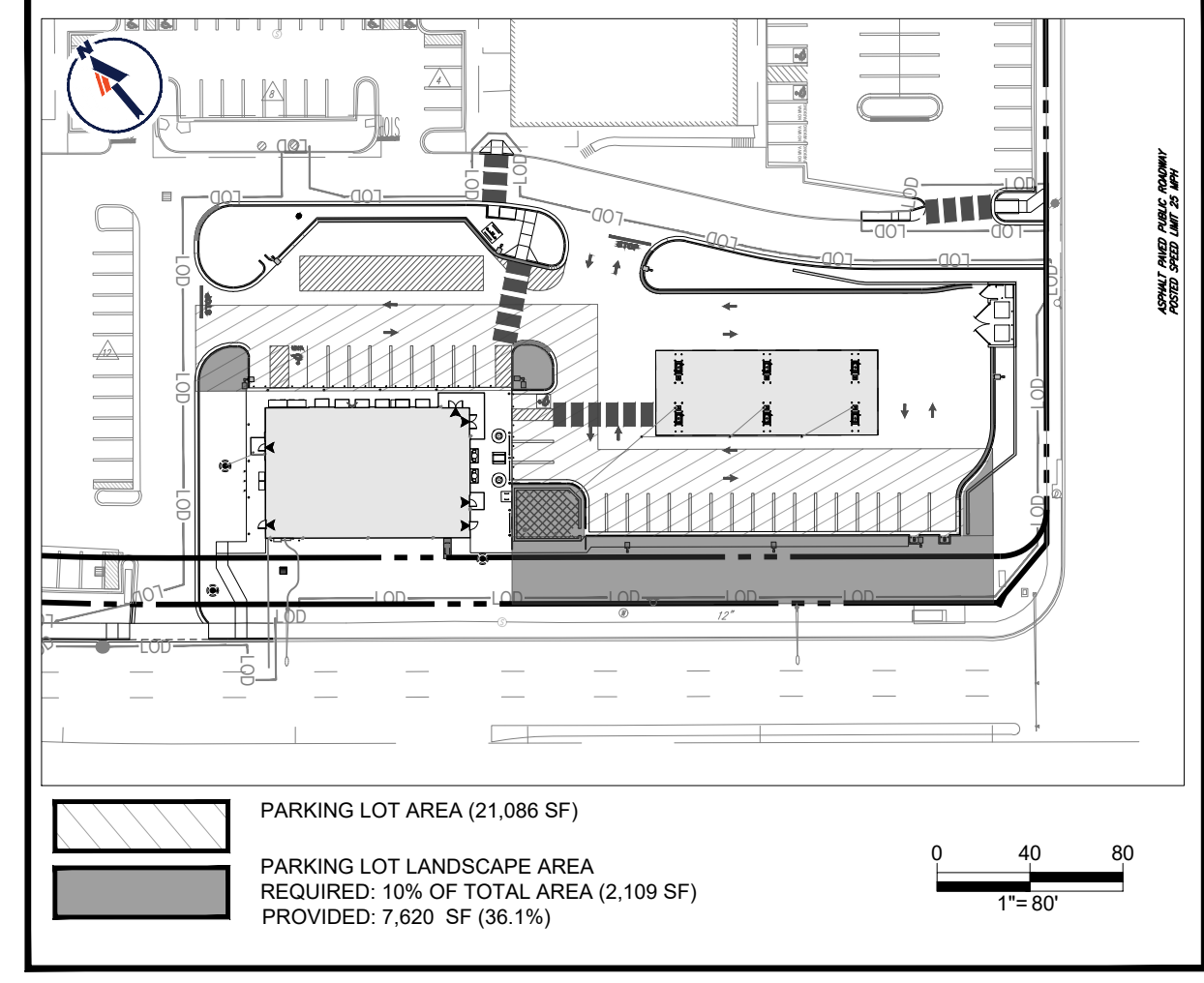

LEGEND

- PROPERTY LINE
- LIMIT OF DISTURBANCE
- EXISTING TREE AND CRZ
- ▨ PROPOSED MICRO-BIORETENTION FACILITY
- PROPOSED LIGHT

SOUTH FREDERICK AVENUE-MD RTE. 355

VARIABLE WIDTH RIGHT-OF-WAY
ASPHALT PAVED PUBLIC ROADWAY
POSTED SPEED LIMIT 40 MPH

LANDSCAPE REQUIREMENTS					
SECTION	CATEGORY	TOTAL AREA(LF)	REQUIRED	PROVIDED	COMPLIES
SEC. 24-220(e)	PARKING LOT LANDSCAPE	21,086 SF	10% OF TOTAL AREA (2,109 SF)	7,620 SF (36.1%)	YES
SEC. 24-237	STREET FRONTAGE	SOUTH WESTLAND DRIVE- 118 L.F.	1/50 LF (3 SHADE TREES)	3 SHADE TREES	YES
	STREET FRONTAGE	SOUTH FREDERICK AVENUE- MD RTE. 355- 343 L.F.	1/50 LF (7 SHADE TREES)	3 PROP. SHADE TREES 4 EXISTING SHADE TREES	YES*
SEC. 24-220(e)	PARKING LOT TREE	15,105 SF	1/PARKING ISLAND (4 SHADE TREES)	4 SHADE TREES	YES

*NOTE: STREET TREE PARKING REQUIREMENT TO BE MET WITH EXISTING TREES TO REMAIN.

MICRO-BIORETENTION AREAS PLANTING SCHEDULE

SPECIES					
BOTANICAL NAME	COMMON NAME	TYPE	SPACING	SIZE	MICRO-BIO RETENTION (579 S.F.)
CLETHERA ALNIFOLIA	SWEET PEPPERBUSH	SHRUB	30" O.C.	1 GAL. CONT.	26
CORNUS AMMOMUM	SILKY DOGWOOD	SHRUB	30" O.C.	1 GAL. CONT.	26
RUDBECKIA HIRTA	BLACK EYE SUSAN	PERENNIAL	12" O.C.	PLUG	65
ASTER NOVAE-ANGLIAE	NEW ENGLAND ASTER	PERENNIAL	12" O.C.	PLUG	65
RUDBECKIA LACINIATA	TALL CONEFLOWER	PERENNIAL	12" O.C.	PLUG	65
JUNCUS EFFUSUS	SOFT RUSH	PERENNIAL	12" O.C.	PLUG	129
SCIRPUS ACUTUS	HARDSTEMMED BULLRUSH	PERENNIAL	12" O.C.	PLUG	129

STATEMENT OF VIABILITY: BASED ON THE SOUTHERN SUN EXPOSURE AND MDE STANDARD BIORETENTION SOILS. THE PLANT MATERIAL SPECIFIED ABOVE IS SUITABLE FOR PART SHADE TO FULL SHADE CONDITIONS, AND MOIST TO WET SOIL SATURATION.

PLANT SCHEDULE

SYMBOL	CODE	QTY	BOTANICAL NAME	COMMON NAME	SIZE	CONTAINER	CANOPY AREA	TOTAL CANOPY (AC)
+	GT1	2	GLEDITSIA TRIACANTHOS INERMIS	THORNLESS HONEY LOCUST	2.5'-3" CAL., 12'-14" HT.	B&B	0.016	0.032
○	PXAB	6	PLATANUS X ACERIFOLIA 'BLOODGOOD'	LONDON PLANE TREE	2.5'-3" CAL., 12'-14" HT.	B&B	0.016	0.096
○	AC	1	ACER RUBRUM	RED MAPLE	2.5'-3" CAL., 12'-14" HT.	B&B	0.016	0.016
○	OPH	5	QUERCUS PHELLOS	WILLOW OAK	2.5'-3" CAL., 12'-14" HT.	B&B	0.016	0.080
○	IA	6	ILEX VERTICILLATA 'AFTERGLOW'	AFTERGLOW WINTERBERRY	24-30" HT. & SPRD	CONTAINER		
○	IG	37	ILEX GLABRA	INKBERRY HOLLY	24-30" HT. & SPRD	CONTAINER		

BOHLER
SITE CIVIL AND CONSULTING ENGINEERING
PROGRAM MANAGEMENT
LANDSCAPE ARCHITECTURE
SUSTAINABLE DESIGN
PERMITTING SERVICES
TRANSPORTATION SERVICES

REVISIONS

REV	DATE	COMMENT	CHECKED BY
1	07/26/2024	REV. PER CITY COMMENTS	AD
2	08/02/2024	REV. PER CITY COMMENTS	RK
3	08/19/2024	REV. PER CITY COMMENTS	EO
		PER CITY COMMENTS	RK
			NG
			BK

811
Know what's below.
Call before you dig.
ALWAYS CALL 811
It's fast. It's free. It's the law.

NOT APPROVED FOR CONSTRUCTION

PROJECT No.: MDC230018.00
DRAWN BY: BK
DATE: 03/19/24
CAD ID: LSCP-1

FINAL SITE PLAN
FOR
SHEETZ WALNUT HILL

LOCATION OF SITE
16529 S FREDERICK AVENUE
MONTGOMERY COUNTY
GAITHERSBURG, MD 20877
TM: FS63, PARCEL: B, BLOCK: A
SUBDIVISION: SECTION ONE
WALNUT HILL

BOHLER
9711 WASHINGTONIAN BLVD, SUITE 375
GAITHERSBURG, MARYLAND 20878
Phone: (301) 809-4500
Fax: (301) 809-4501
MD@BohlerEng.com

9/5/2024
D.H. PARK
REGISTERED LANDSCAPE ARCHITECT
I, D.H. PARK, HEREBY CERTIFY THAT THESE DOCUMENTS WERE PREPARED OR APPROVED BY ME, AND THAT I AM A DULY LICENSED LANDSCAPE ARCHITECT UNDER THE LAWS OF THE STATE OF MARYLAND, LICENSE NO. 3894, EXPIRATION DATE: 04-22-28

SHEET TITLE:
LANDSCAPE PLAN

SHEET NUMBER:
L-101

REVISION 3 - 08/19/2024

GENERAL NOTE: IT IS THE RESPONSIBILITY OF THE CONTRACTOR TO REVIEW ALL OF THE DRAWINGS AND SPECIFICATIONS ASSOCIATED WITH THIS PROJECT WORK SCOPE PRIOR TO THE INITIATION OF CONSTRUCTION. SHOULD THE CONTRACTOR FIND A CONFLICT WITH THE DOCUMENTS RELATIVE TO THE SPECIFICATIONS OR APPLICABLE CODES, IT IS THE CONTRACTOR'S RESPONSIBILITY TO NOTIFY THE PROJECT ENGINEER OF RECORD IN WRITING PRIOR TO THE START OF CONSTRUCTION. FAILURE BY THE CONTRACTOR TO NOTIFY THE PROJECT ENGINEER SHALL CONSTITUTE ACCEPTANCE OF FULL RESPONSIBILITY BY THE CONTRACTOR TO COMPLETE THE SCOPE OF THE WORK AS DEFINED BY THE DRAWINGS AND IN FULL COMPLIANCE WITH LOCAL, REGIONAL AND STATE CODES.

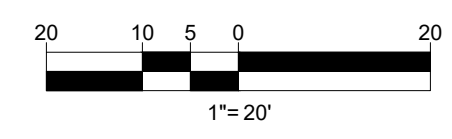

LANDSCAPE SPECIFICATIONS

1. SCOPE OF WORK:
THE LANDSCAPE CONTRACTOR SHALL BE REQUIRED TO PERFORM ALL CLEARING, FINISHED GRADING, SOIL PREPARATION, PERMANENT SEEDING OR SODDING, PLANTING AND MULCHING INCLUDING ALL LABOR, MATERIALS, TOOLS AND EQUIPMENT NECESSARY FOR THE COMPLETION OF THIS PROJECT, UNLESS OTHERWISE CONTRACTED BY THE GENERAL CONTRACTOR.

2. MATERIALS
A. GENERAL - ALL HARDSCAPE MATERIALS SHALL MEET OR EXCEED SPECIFICATIONS AS OUTLINED IN THE STATE DEPARTMENT OF TRANSPORTATION'S SPECIFICATIONS.
B. TOPSOIL - NATURAL, FRIABLE, LOAMY SILT SOIL HAVING AN ORGANIC CONTENT NOT LESS THAN 5%, A PH RANGE BETWEEN 4.5-7.0. IT SHALL BE FREE OF DEBRIS, ROCKS LARGER THAN ONE INCH (1"), WOOD, ROOTS, VEGETABLE MATTER AND CLAY CLODS.

C. LAWN - ALL DISTURBED AREAS ARE TO BE TREATED WITH A MINIMUM SIX INCH (6") THICK LAYER OF TOPSOIL, OR AS DIRECTED BY THE LOCAL ORDINANCE OR CLIENT, AND SEEDED OR SODDED IN ACCORDANCE WITH THE PERMANENT STABILIZATION METHODS INDICATED WITHIN THE SOIL EROSION AND SEDIMENT CONTROL NOTES.
1. LAWN SEED MIXTURE SHALL BE FRESH, CLEAN SEED (CROP SEED).
2. SOD SHALL BE STRONGLY ROOTED, WEED AND DISEASE/PEST FREE WITH A UNIFORM THICKNESS.
3. SOD INSTALLED ON SLOPES GREATER THAN 4:1 SHALL BE PEGGED TO HOLD SOD IN PLACE.

D. MULCH - THE MULCH AROUND THE PERIMETER OF THE BUILDING SHALL BE A 3" LAYER OF DOUBLE SHREDDED BLACK CEDAR MULCH ONLY. ALL OTHER AREAS SHALL BE MULCHED WITH A 3" LAYER OF DOUBLE SHREDDED DARK BROWN HARDWOOD BARK MULCH, UNLESS OTHERWISE STATED ON THE LANDSCAPE PLAN.

E. FERTILIZER
1. FERTILIZER SHALL BE DELIVERED TO THE SITE MIXED AS SPECIFIED IN THE ORIGINAL UNOPENED STANDARD BAGS SHOWING WEIGHT, ANALYSIS AND NAME OF MANUFACTURER. FERTILIZER SHALL BE STORED IN A WEATHERPROOF PLACE SO THAT IT CAN BE KEPT DRY PRIOR TO USE.
2. FOR THE PURPOSE OF BIDDING, ASSUME THAT FERTILIZER SHALL BE 10% NITROGEN, 6% PHOSPHORUS AND 4% POTASSIUM BY WEIGHT. A FERTILIZER SHOULD NOT BE SELECTED WITHOUT A SOIL TEST PERFORMED BY A CERTIFIED SOIL LABORATORY.

F. PLANT MATERIAL
1. ALL PLANTS SHALL IN ALL CASES CONFORM TO THE REQUIREMENTS OF THE AMERICAN STANDARD FOR NURSERY STOCK (ANSI Z60.1), LATEST EDITION, AS PUBLISHED BY THE AMERICAN NURSERY & LANDSCAPE ASSOCIATION.
2. IN ALL CASES, BOTANICAL NAMES SHALL TAKE PRECEDENCE OVER COMMON NAMES FOR ANY AND ALL PLANT MATERIAL.
3. PLANTS SHALL BE LEGIBLY TAGGED WITH THE PROPER NAME AND SIZE. TAGS ARE TO REMAIN ON AT LEAST ONE PLANT OF EACH SPECIES FOR VERIFICATION PURPOSES DURING THE FINAL INSPECTION.
4. TREES WITH ABRASION OF THE BARK, SUN SCALDS, DISFIGURATION OR FRESH CUTS OF LIMBS OVER 1/4", WHICH HAVE NOT BEEN COMPLETELY HEALED, SHALL BE REJECTED. PLANTS SHALL NOT BE BOUND WITH WIRE OR ROPE AT ANY TIME SO AS TO DAMAGE THE BARK OR BREAK BRANCHES.
5. ALL PLANTS SHALL BE TYPICAL OF THEIR SPECIES OR VARIETY AND SHALL HAVE A NORMAL HABIT OF GROWTH WELL DEVELOPED BRANCHES, DENSELY FOLIATED, VIGOROUS ROOT SYSTEMS AND BE FREE OF DISEASE, INSECTS, PESTS, EGGS OR LARVAE.
6. CALIPER MEASUREMENTS OF NURSERY GROWN TREES SHALL BE TAKEN AT A POINT ON THE TRUNK SIX INCHES (6") ABOVE THE NATURAL GRADE FOR TREES UP TO AND INCLUDING A FOUR INCH (4") CALIPER SIZE. IF THE CALIPER AT SIX INCHES (6") ABOVE THE GROUND EXCEEDS FOUR INCHES (4") IN CALIPER, THE CALIPER SHOULD BE MEASURED AT A POINT 12" ABOVE THE NATURAL GRADE.
7. SHRUBS SHALL BE MEASURED TO THE AVERAGE HEIGHT OR SPREAD OF THE SHRUB, AND NOT TO THE LONGEST BRANCH.
8. TREES AND SHRUBS SHALL BE HANDLED WITH CARE BY THE ROOT BALL.

3. GENERAL WORK PROCEDURES
A. CONTRACTOR TO UTILIZE WORKMANLIKE INDUSTRY STANDARDS IN PERFORMING ALL LANDSCAPE CONSTRUCTION. THE SITE IS TO BE LEFT IN A CLEAN STATE AT THE END OF EACH WORKDAY. ALL DEBRIS, MATERIALS AND TOOLS SHALL BE PROPERLY STORED, STOCKPILED OR DISPOSED OF.
B. WASTE MATERIALS AND DEBRIS SHALL BE COMPLETELY DISPOSED OF AT THE CONTRACTOR'S EXPENSE. DEBRIS SHALL NOT BE BURIED, INCLUDING ORGANIC MATERIALS, BUT SHALL BE REMOVED COMPLETELY FROM THE SITE.

4. SITE PREPARATIONS
A. BEFORE AND DURING PRELIMINARY GRADING AND FINISHED GRADING, ALL WEEDS AND GRASSES SHALL BE DUG OUT BY THE ROOTS AND DISPOSED OF IN ACCORDANCE WITH GENERAL WORK PROCEDURES OUTLINED HEREIN.
B. ALL EXISTING TREES TO REMAIN SHALL BE PRUNED TO REMOVE ANY DAMAGED BRANCHES. THE ENTIRE LIMB OF ANY DAMAGED BRANCH SHALL BE CUT OFF AT THE TRUNK. CONTRACTOR SHALL ENSURE THAT CUTS ARE SMOOTH AND STRAIGHT, AND EXISTING ROOTS SHALL BE CUT BACK WITH CLEAN, SHARP TOOLS AND TOPSOIL SHALL BE PLACED AROUND THE REMAINDER OF THE ROOTS. EXISTING TREES SHALL BE MONITORED ON A REGULAR BASIS FOR ADDITIONAL ROOT OR BRANCH DAMAGE AS A RESULT OF CONSTRUCTION. ROOTS SHALL NOT BE LEFT EXPOSED FOR MORE THAN ONE (1) DAY. CONTRACTOR SHALL WATER EXISTING TREES AS NEEDED TO PREVENT SHOCK OR DECLINE.
C. CONTRACTOR SHALL ARRANGE TO HAVE A UTILITY STAKE-OUT TO LOCATE ALL UNDERGROUND UTILITIES PRIOR TO INSTALLATION OF ANY LANDSCAPE MATERIAL. UTILITY COMPANIES SHALL BE CONTACTED THREE (3) DAYS PRIOR TO THE BEGINNING OF WORK.

5. TREE PROTECTION
A. CONTRACTOR SHALL BE RESPONSIBLE FOR THE PROTECTION OF ALL EXISTING TREES TO REMAIN. A TREE PROTECTION ZONE SHALL BE ESTABLISHED AT THE DRIP LINE OR 15 FEET FROM THE TRUNK OR AT THE LIMIT OF CONSTRUCTION DISTURBANCE, WHICHEVER IS GREATER. LOCAL STANDARDS THAT MAY REQUIRE A MORE STRICT TREE PROTECTION ZONE SHALL BE HONORED.
B. A FORTY-EIGHT INCH (48") HIGH WOODEN SNOW FENCE OR ORANGE COLORED HIGH-DENSITY VISI-FENCE, OR APPROVED EQUAL, MOUNTED ON STEEL POSTS SHALL BE PLACED ALONG THE BOUNDARY OF THE TREE PROTECTION ZONE. POSTS SHALL BE LOCATED AT A MAXIMUM OF EIGHT FEET (8') ON CENTER OR AS INDICATED WITHIN THE TREE PROTECTION DETAIL.
C. WHEN THE TREE PROTECTION FENCING HAS BEEN INSTALLED, IT SHALL BE INSPECTED BY THE APPROVING AGENCY PRIOR TO DEMOLITION OF EXISTING TREE CLEARINGS OR ANY CONSTRUCTION. THE FENCING ALONG THE TREE PROTECTION ZONE SHALL BE REGULARLY INSPECTED BY THE LANDSCAPE CONTRACTOR AND MAINTAINED UNTIL ALL CONSTRUCTION ACTIVITY HAS BEEN COMPLETED.
D. AT NO TIME SHALL MACHINERY, DEBRIS, FALLEN TREES OR OTHER MATERIALS BE PLACED, STOCKPILED OR LEFT STANDING IN THE TREE PROTECTION ZONE.

6. SOIL MODIFICATIONS
A. CONTRACTOR SHALL ATTAIN A SOIL TEST FOR ALL AREAS OF THE SITE PRIOR TO CONDUCTING ANY PLANTING. SOIL TESTS SHALL BE PERFORMED BY A CERTIFIED SOIL LABORATORY.
B. LANDSCAPE CONTRACTOR SHALL REPORT ANY SOIL OR DRAINAGE CONDITIONS CONSIDERED DETRIMENTAL TO THE GROWTH OF PLANT MATERIAL. SOIL MODIFICATIONS, AS SPECIFIED HEREIN, MAY BE REQUIRED TO BE CONDUCTED BY THE LANDSCAPE CONTRACTOR DEPENDING ON SITE CONDITIONS.
C. THE FOLLOWING AMENDMENTS AND QUANTITIES ARE APPROXIMATE AND ARE FOR BIDDING PURPOSES ONLY. COMPOSITION OF AMENDMENTS SHOULD BE REVISED DEPENDING ON THE OUTCOME OF A TOPSOIL ANALYSIS PERFORMED BY A CERTIFIED SOIL LABORATORY.
1.1. TO INCREASE A SANDY SOIL'S ABILITY TO RETAIN WATER AND NUTRIENTS, THOROUGHLY TILL ORGANIC MATTER INTO THE TOP 6-12". USE COMPOSTED BARK, COMPOSTED LEAF MULCH OR PEAT MOSS. ALL PRODUCTS SHOULD BE COMPOSTED TO A DARK COLOR AND BE FREE OF PIECES WITH IDENTIFIABLE LEAF OR WOOD STRUCTURE. AVOID MATERIAL WITH A PH HIGHER THAN 7.5.
1.2. TO INCREASE DRAINAGE, MODIFY HEAVY CLAY OR SILT (MORE THAN 40% CLAY OR SILT) BY ADDING COMPOSTED PINE BARK (UP TO 30% BY VOLUME) AND/OR AGRICULTURAL GYPSUM. COARSE SAND MAY BE USED IF ENOUGH IS AVAILABLE TO BRING THE SAND CONTENT TO MORE THAN 60% OF THE TOTAL MIX. SUBSURFACE DRAINAGE LINES MAY BE ADDED TO INCREASE DRAINAGE.
1.3. MODIFY EXTREMELY SANDY SOILS (MORE THAN 85%) BY ADDING ORGANIC MATTER AND/OR DRY, SHREDDED CLAY LOAM UP TO 30% OF THE TOTAL MIX.

7. FINISHED GRADING
A. UNLESS OTHERWISE CONTRACTED, THE LANDSCAPE CONTRACTOR SHALL BE RESPONSIBLE FOR THE INSTALLATION OF TOPSOIL AND THE ESTABLISHMENT OF FINE-GRADING WITHIN THE DISTURBANCE AREA OF THE SITE.
B. LANDSCAPE CONTRACTOR SHALL VERIFY THAT SUBGRADE FOR INSTALLATION OF TOPSOIL HAS BEEN ESTABLISHED. THE SUBGRADE OF THE SITE MUST MEET THE FINISHED GRADE LESS THE REQUIRED TOPSOIL THICKNESS (1-3).
C. ALL LAWN AND PLANTING AREAS SHALL BE GRADED TO A SMOOTH, EVEN AND UNIFORM PLANE WITH NO ABRUPT CHANGE OF SURFACE AS SPECIFIED WITHIN THIS SET OF CONSTRUCTION PLANS, UNLESS OTHERWISE DIRECTED BY THE PROJECT ENGINEER OR LANDSCAPE ARCHITECT.
D. ALL PLANTING AREAS SHALL BE GRADED AND MAINTAINED TO ALLOW FREE FLOW OF SURFACE WATER IN AND AROUND THE PLANTING BEDS. STANDING WATER SHALL NOT BE PERMITTED IN PLANTING BEDS.

8. TOPSOILING
A. CONTRACTOR SHALL PROVIDE A SIX INCH (6") THICK MINIMUM LAYER OF TOPSOIL, OR AS DIRECTED BY THE LOCAL ORDINANCE OR CLIENT, IN ALL PLANTING AREAS. TOPSOIL SHOULD BE SPREAD OVER A PREPARED SURFACE IN A UNIFORM LAYER TO ACHIEVE THE DESIRED COMPACTED THICKNESS.
B. ON-SITE TOPSOIL MAY BE USED TO SUPPLEMENT THE TOTAL AMOUNT REQUIRED. TOPSOIL FROM THE SITE MAY BE REJECTED IF IT HAS NOT BEEN PROPERLY REMOVED, STORED AND PROTECTED PRIOR TO CONSTRUCTION.
C. CONTRACTOR SHALL FURNISH TO THE APPROVING AGENCY AND ANALYSIS OF BOTH IMPORTED AND ON-SITE TOPSOIL TO BE UTILIZED IN ALL PLANTING AREAS. THE PH AND NUTRIENT LEVELS MAY BE ADJUSTED THROUGH SOIL MODIFICATIONS AS NEEDED TO ACHIEVE THE REQUIRED LEVELS AS SPECIFIED IN THE MATERIALS SECTION ABOVE.
D. ALL PLANTING AND LAWN AREAS SHALL BE CULTIVATED TO A DEPTH OF SIX INCHES (6"). ALL DEBRIS EXPOSED FROM EXCAVATION AND CULTIVATION SHALL BE DISPOSED OF IN ACCORDANCE WITH GENERAL WORK PROCEDURES SECTION ABOVE. THE FOLLOWING SHALL BE FILLED INTO THE TOP FOUR INCHES (4") IN TWO DIRECTIONS (QUANTITIES BASED ON A 1,000 SQUARE FOOT AREA).
1.1. 20 POUNDS GROW POWER OR APPROVED EQUAL
1.2. 20 POUNDS NITRO-FORM (COURSE) 38-0-0 BLUE CHIP
E. THE SPREADING OF TOPSOIL SHALL NOT BE CONDUCTED UNDER MUDDY OR FROZEN CONDITIONS.

9. PLANTING
A. INSOFAR THAT IT IS FEASIBLE, PLANT MATERIAL SHALL BE PLANTED ON THE DAY OF DELIVERY. IN THE EVENT THAT THIS IS NOT POSSIBLE, LANDSCAPE CONTRACTOR SHALL PROTECT UNINSTALLED PLANT MATERIAL. PLANTS SHALL NOT REMAIN UNPLANTED FOR LONGER THAN A THREE DAY PERIOD AFTER DELIVERY. PLANTS THAT WILL NOT BE PLANTED FOR A PERIOD OF TIME GREATER THAN THREE DAYS SHALL BE HEALED IN WITH TOPSOIL OR MULCH TO HELP PRESERVE ROOT MOISTURE.
B. PLANTING OPERATIONS SHALL BE PERFORMED DURING PERIODS WITHIN THE PLANTING SEASON WHEN WEATHER AND SOIL CONDITIONS ARE SUITABLE AND IN ACCORDANCE WITH ACCEPTED LOCAL PRACTICE. PLANTS SHALL NOT BE INSTALLED IN TOPSOIL THAT IS IN A MUDDY OR FROZEN CONDITION.
C. ANY INJURED ROOTS OR BRANCHES SHALL BE PRUNED TO MAKE CLEAN-CUT ENDS PRIOR TO PLANTING UTILIZING CLEAN, SHARP TOOLS. ONLY INJURED OR DISEASED BRANCHING SHALL BE REMOVED.
D. ALL PLANTING CONTAINERS AND NON-BIODEGRADABLE MATERIALS SHALL BE REMOVED FROM ROOT BALLS DURING PLANTING. NATURAL FIBER BURLAP MUST BE CUT FROM AROUND THE TRUNK OF THE TREE AND FOLDED DOWN AGAINST THE ROOT BALL PRIOR TO BACKFILLING.
E. POSITION TREES AND SHRUBS AT THEIR INTENDED LOCATIONS AS PER THE PLANS AND SECURE THE APPROVAL OF THE LANDSCAPE ARCHITECT PRIOR TO EXCAVATING PITS, MAKING NECESSARY ADJUSTMENTS AS DIRECTED.
F. PRIOR TO THE ISSUANCE OF ANY CERTIFICATE OF OCCUPANCY, THE PROPOSED LANDSCAPE, AS SHOWN ON THE APPROVED LANDSCAPE PLAN, MUST BE INSTALLED, INSPECTED AND APPROVED BY THE APPROVING AGENCY. THE APPROVING AGENCY SHALL TAKE INTO ACCOUNT SEASONAL CONSIDERATIONS IN THIS REGARD AS FOLLOWS. THE PLANTING OF TREES, SHRUBS, VINES OR GROUND COVER SHALL OCCUR ONLY DURING THE FOLLOWING PLANTING SEASONS:
1.1. PLANTS: MARCH 15 TO DECEMBER 15
1.2. LAWN: MARCH 15 TO JUNE 15 OR SEPT. 1 TO DECEMBER 1
G. PLANTINGS REQUIRED FOR A CERTIFICATE OF OCCUPANCY SHALL BE PROVIDED DURING THE NEXT APPROPRIATE SEASON AT THE MUNICIPALITY'S DISCRETION. CONTRACTOR SHOULD CONTACT APPROVING AGENCY FOR POTENTIAL SUBSTITUTIONS.
H. FURTHERMORE, THE FOLLOWING TREE VARIETIES ARE UNUSUALLY SUSCEPTIBLE TO WINTER DAMAGE. WITH TRANSPARENT SHOCK AND THE SEASONAL LACK OF NITROGEN AVAILABILITY, THE RISK OF PLANT DEATH IS GREATLY INCREASED. IT IS NOT RECOMMENDED THAT THESE SPECIES BE PLANTED DURING THE FALL PLANTING SEASON:
ACER RUBRUM PLATANUS X ACERIFOLIA
BETULA VARIETIES POPULUS VARIETIES
CARPINUS VARIETIES PRUNUS VARIETIES
CRATAEGUS VARIETIES PYRUS VARIETIES
KOELFUERIENA QUERCUS VARIETIES
LIQUIDAMBAR STRYRACILLUA TILIA TOMENTOSA
LIRIODENDRON TULIPIFERA ZELKOVA VARIETIES

I. PLANTING PITS SHALL BE DUG WITH LEVEL BOTTOMS, WITH THE WIDTH TWICE THE DIAMETER OF ROOT BALL. THE ROOT BALL SHALL REST ON UNDISTURBED GRADE. EACH PLANT PIT SHALL BE BACKFILLED IN LAYERS WITH THE FOLLOWING PREPARED SOIL, MIXED THOROUGHLY:
• 1 PART PEAT MOSS
• 1 PART COMPOSTED COW MANURE BY VOLUME
• 3 PARTS TOPSOIL BY VOLUME
• 21 GRAMS 'AGRIFORM' PLANTING TABLETS (OR APPROVED EQUAL) AS FOLLOWS:
A) 3 TABLETS PER 1 GALLON PLANT
B) 3 TABLETS PER 5 GALLON PLANT
C) 4 TABLETS PER 15 GALLON PLANT
D) LARGER PLANTS: 2 TABLETS PER 1/2" CALIPER OF TRUNK
J. FILL PREPARED SOIL AROUND BALL OF PLANT HALF-WAY AND INSERT PLANT TABLETS. COMPLETE BACKFILL AND WATER THOROUGHLY.
K. ALL PLANTS SHALL BE PLANTED SO THAT THE TOP OF THE ROOT BALL, THE POINT AT WHICH THE ROOT FLARE BEGINS, IS SET AT GROUND LEVEL AND IN THE CENTER OF THE PIT. NO SOIL IS TO BE PLACED DIRECTLY ON TOP OF THE ROOT BALL.
L. ALL PROPOSED TREES DIRECTLY ADJACENT TO WALKWAYS OR DRIVEWAYS SHALL BE PRUNED AND MAINTAINED TO A MINIMUM BRANCHING HEIGHT OF 7' FROM GRADE.
M. GROUND COVER AREAS SHALL RECEIVE A 1/2" LAYER OF HUMUS RAKED INTO THE TOP 1" OF PREPARED SOIL PRIOR TO PLANTING. ALL GROUND COVER AREAS SHALL BE WEEDED AND TREATED WITH A PRE-EMERGENT CHEMICAL AS PER MANUFACTURER'S RECOMMENDATION.
N. NO PLANT, EXCEPT GROUND COVERS, GRASSES OR VINES, SHALL BE PLANTED LESS THAN TWO FEET (2') FROM EXISTING STRUCTURES AND SIDEWALKS.
O. ALL PLANTING AREAS AND PLANTING PITS SHALL BE MULCHED AS SPECIFIED HEREIN TO FILL THE ENTIRE BED AREA OR SAUCER. NO MULCH IS TO TOUCH THE TRUNK OF THE TREE OR SHRUB.
P. ALL PLANTING AREAS SHALL BE WATERED IMMEDIATELY UPON INSTALLATION IN ACCORDANCE WITH THE WATERING SPECIFICATIONS AS LISTED HEREIN.

10. TRANSPLANTING (WHEN REQUIRED)
A. ALL TRANSPLANTS SHALL BE DUG WITH INTACT ROOT BALLS CAPABLE OF SUSTAINING THE PLANT.
B. IF PLANTS ARE TO BE STOCKPILED BEFORE REPLANTING, THEY SHALL BE HEALED IN WITH MULCH OR SOIL, ADEQUATELY WATERED AND PROTECTED FROM EXTREME HEAT, SUN AND WIND.
C. PLANTS SHALL NOT BE DUG FOR TRANSPLANTING BETWEEN APRIL 10 AND JUNE 30.
D. UPON REPLANTING, BACKFILL SOIL SHALL BE AMENDED WITH FERTILIZER AND ROOT GROWTH HORMONE.
E. TRANSPLANTS SHALL BE GUARANTEED FOR THE LENGTH OF THE GUARANTEE PERIOD SPECIFIED HEREIN.

11. WATERING
A. NEW PLANTINGS OR LAWN AREAS SHALL BE ADEQUATELY IRRIGATED BEGINNING IMMEDIATELY AFTER PLANTING. WATER SHALL BE APPLIED TO EACH TREE AND SHRUB IN SUCH MANNER AS NOT TO DISTURB BACKFILL AND TO THE EXTENT THAT ALL MATERIALS IN THE PLANTING HOLE ARE THOROUGHLY SATURATED. WATERING SHALL CONTINUE AT LEAST UNTIL PLANTS ARE ESTABLISHED.
B. SITE OWNER SHALL PROVIDE WATER IF AVAILABLE ON SITE AT TIME OF PLANTING. IF WATER IS NOT AVAILABLE ON SITE, CONTRACTOR SHALL SUPPLY ALL NECESSARY WATER. THE USE OF WATER BAGS IS RECOMMENDED FOR ALL NEWLY PLANTED TREES.
C. IF AN IRRIGATION SYSTEM HAS BEEN INSTALLED ON THE SITE, IT SHALL BE USED TO WATER PROPOSED PLANT MATERIAL, BUT ANY FAILURE OF THE SYSTEM DOES NOT ELIMINATE THE CONTRACTOR'S RESPONSIBILITY OF MAINTAINING THE DESIRED MOISTURE LEVEL FOR VIGOROUS, HEALTHY GROWTH.

12. GUARANTEE
A. THE LANDSCAPE CONTRACTOR SHALL GUARANTEE ALL PLANTS FOR A PERIOD OF ONE (1) YEAR FROM APPROVAL OF LANDSCAPE INSTALLATION BY THE APPROVING AGENCY. CONTRACTOR SHALL SUPPLY THE OWNER WITH A MAINTENANCE BOND FOR TEN PERCENT (10%) OF THE VALUE OF THE LANDSCAPE INSTALLATION WHICH WILL BE RELEASED AT THE CONCLUSION OF THE GUARANTEE PERIOD AND WHEN A FINAL INSPECTION HAS BEEN COMPLETED AND APPROVED BY THE OWNER OR AUTHORIZED REPRESENTATIVE.
B. ANY DEAD OR DYING PLANT MATERIAL SHALL BE REPLACED FOR THE LENGTH OF THE GUARANTEE PERIOD. REPLACEMENT OF PLANT MATERIAL SHALL BE CONDUCTED AT THE FIRST SUCCEEDING PLANTING SEASON. ANY DEBRIS SHALL BE DISPOSED OF OFF-SITE, WITHOUT EXCEPTION.
C. TREES AND SHRUBS SHALL BE MAINTAINED BY THE CONTRACTOR DURING CONSTRUCTION AND THROUGHOUT THE 90 DAY MAINTENANCE PERIOD AS SPECIFIED HEREIN. CULTIVATION, WEEDING, WATERING AND THE PREVENTATIVE TREATMENTS SHALL BE PERFORMED AS NECESSARY TO KEEP PLANT MATERIAL IN GOOD CONDITION AND FREE OF INSECTS AND DISEASE.
D. LAWNS SHALL BE MAINTAINED THROUGH WATERING, FERTILIZING, WEEDING, MOWING, TRIMMING AND OTHER OPERATIONS SUCH AS ROLLING, REGARDING AND REPLANTING AS REQUIRED TO ESTABLISH A SMOOTH, ACCEPTABLE LAWN, FREE OF ERODED OR BARE AREAS.

13. CLEANUP
A. UPON THE COMPLETION OF ALL LANDSCAPE INSTALLATION AND BEFORE THE FINAL ACCEPTANCE, THE CONTRACTOR SHALL REMOVE ALL UNUSED MATERIALS, EQUIPMENT AND DEBRIS FROM THE SITE. ALL PAVED AREAS ARE TO BE CLEANED.
B. THE SITE SHALL BE CLEANED AND LEFT IN A NEAT AND ACCEPTABLE CONDITION AS APPROVED BY THE OWNER OR AUTHORIZED REPRESENTATIVE.

14. CITY OF GAITHERSBURG - GENERAL NOTES
A. INDIVIDUAL HOMEOWNERS MUST BE NOTIFIED AT LEAST ONE WEEK PRIOR TO INSTALLATION OF PLANTS ON LOTS THAT HAVE AN OCCUPIED DWELLING.
B. UNLESS OTHERWISE STIPULATED BY SPECIFIC REQUIREMENTS OF THIS MANUAL, THE LANDSCAPING SHOWN ON THIS PLAN MUST BE INSTALLED IN ACCORDANCE WITH THE LATEST EDITION OF LANDSCAPE SPECIFICATION GUIDELINES, DEVELOPED BY THE MD-DC-VA CHAPTER OF THE LANDSCAPE CONTRACTORS ASSOCIATION.
C. ALL TREES ARE TO BE LOCATED A MINIMUM DISTANCE OF 5 FEET FROM ALL UTILITY BOXES, 5 FEET FROM A STORM DRAIN INLET OR MAN-HOLE, 10 FEET FROM A FIRE HYDRANT, 15 FEET FROM PUBLIC STREET LIGHTS, 5 FEET FROM DRIVEWAY APRONS, 20 FEET FROM ANY TRAFFIC CONTROL SIGN, AND AT LEAST 30 FEET FROM ANY INTERSECTION.
D. LOCATIONS OF STREET TREES MAY BE SUBJECT TO CHANGE IN ORDER TO AVOID CONFLICT WITH STREET LIGHTING.
E. ANY PLANTING WITHIN A FOREST RETENTION AREA, AS DESIGNATED ON THE FOREST CONSERVATION PLAN AND SHOWN ON THIS PLAN, MUST BE DONE TO AVOID ANY ADVERSE IMPACT TO THE ROOTS OF EXISTING TREES.
F. PLANT TYPE SUBSTITUTIONS ARE PERMITTED WITH VERBAL OR WRITTEN APPROVAL FROM THE PLANNING AND CODE ADMINISTRATION.
G. ALL PLANT MATERIAL WILL BE REINSPECTED FOR SURVIVAL BY THE PLANNING AND CODE ADMINISTRATION ONE YEAR FOLLOWING INSTALLATION. A 10 PERCENT MAINTENANCE BOND WILL BE RETAINED DURING THIS RIME PERIOD.
H. ALL PLANTS MUST MEET THE STANDARDS OF THE LATEST EDITION OF AMERICAN STANDARD FOR NURSERY STOCK SPONSORED BY THE ASSOCIATION OF AMERICAN NURSERYMEN.
I. NO PLANT SHALL BE LOCATED IN AREAS OF OBVIOUS POOR DRAINAGE, IF SUCH CONDITIONS EXIST, CONTACT THE LANDSCAPE ARCHITECT IMMEDIATELY TO RELOCATE AFFECTED PLANT MATERIALS.
J. SOIL CONDITIONS MUST BE TESTED, VERIFIED AND ADJUSTED BY THE LANDSCAPE CONTRACTOR TO INSURE THAT APPROPRIATE SOIL COMPOSITION AND PH LEVELS ARE SUITABLE FOR PLANT MATERIALS SPECIFIED FOR THAT SPECIFIC LOCATION.

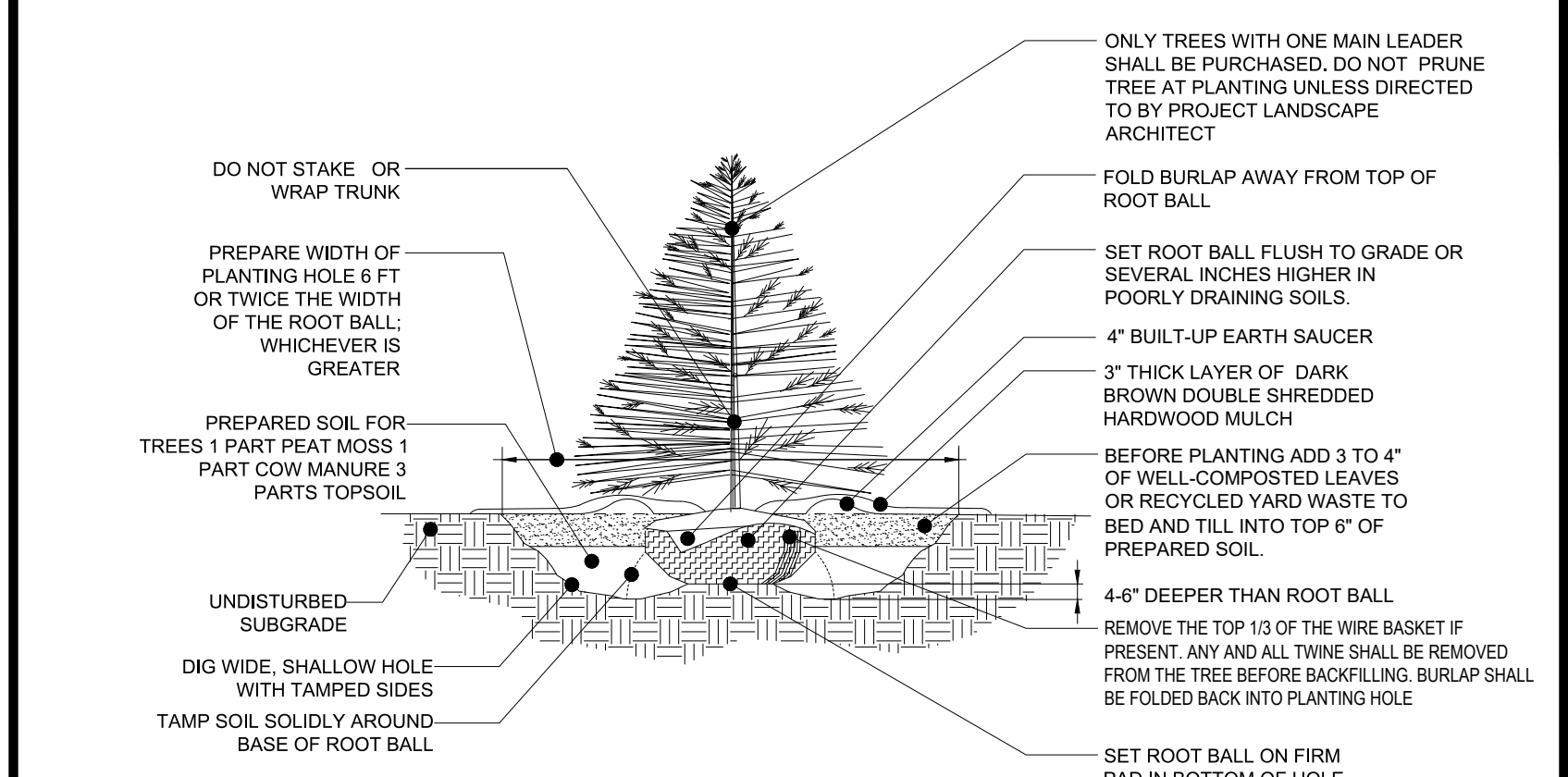

REFERENCE: ARCHITECTURAL GRAPHIC STANDARDS 1998 CUMULATIVE SUPPLEMENT.
EVERGREEN TREE PLANTING DETAIL
NOT TO SCALE

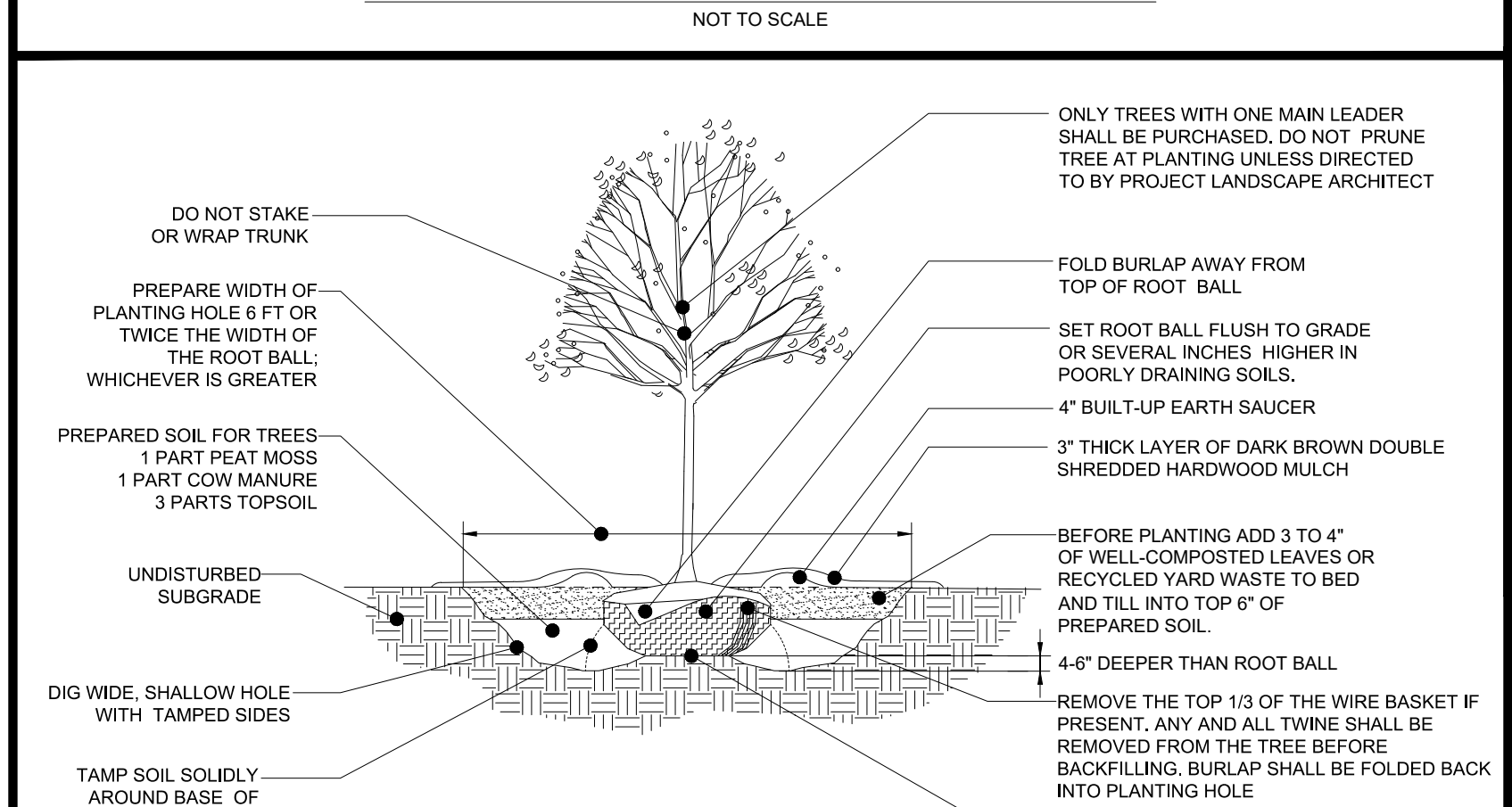

REFERENCE: ARCHITECTURAL GRAPHIC STANDARDS 1998 CUMULATIVE SUPPLEMENT.
DECIDUOUS TREE PLANTING DETAIL
NOT TO SCALE

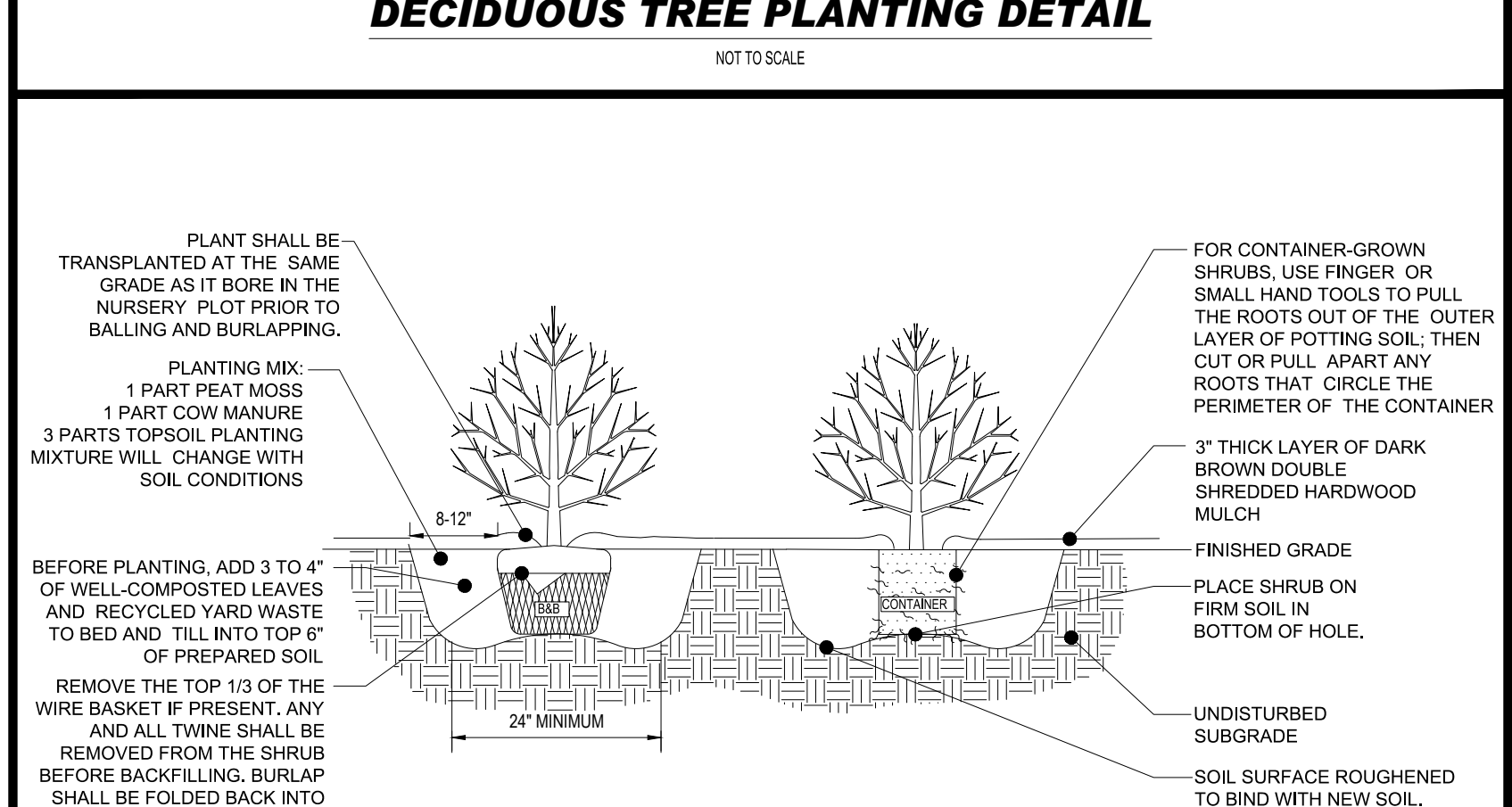

REFERENCE: ARCHITECTURAL GRAPHIC STANDARDS 1998 CUMULATIVE SUPPLEMENT.
DECIDUOUS AND EVERGREEN SHRUB PLANTING DETAIL
NOT TO SCALE

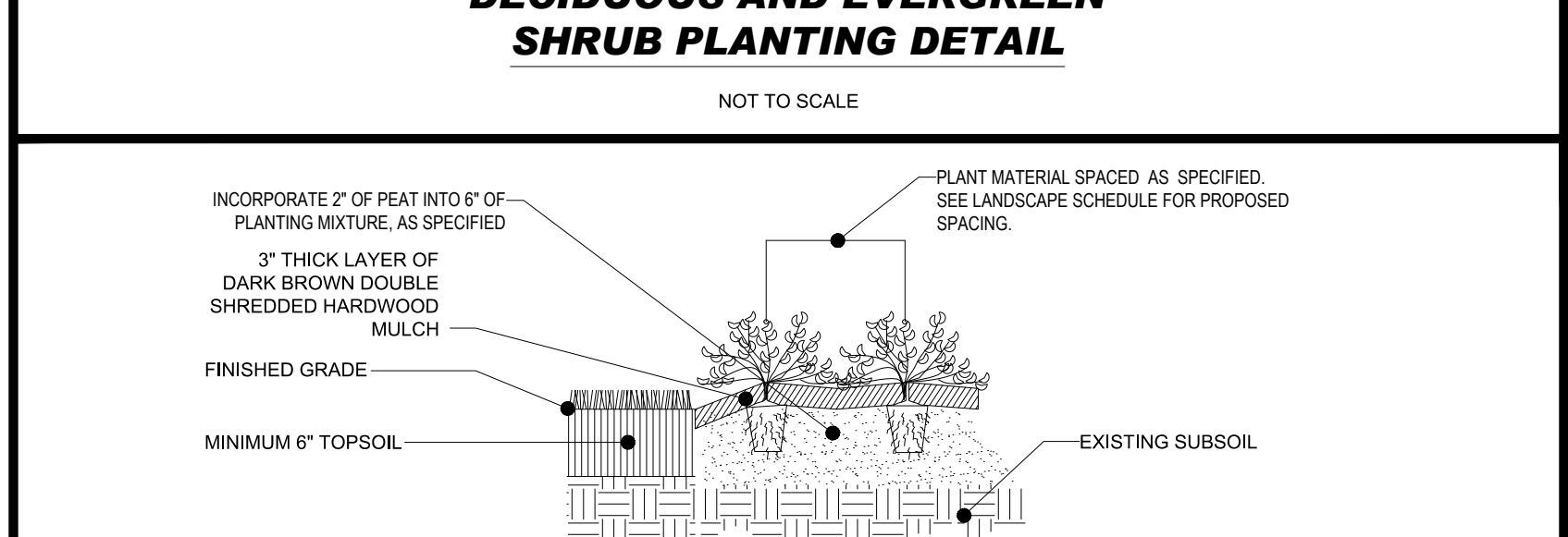

TYPICAL PERENNIAL AND GROUND COVER PLANTING
NOT TO SCALE

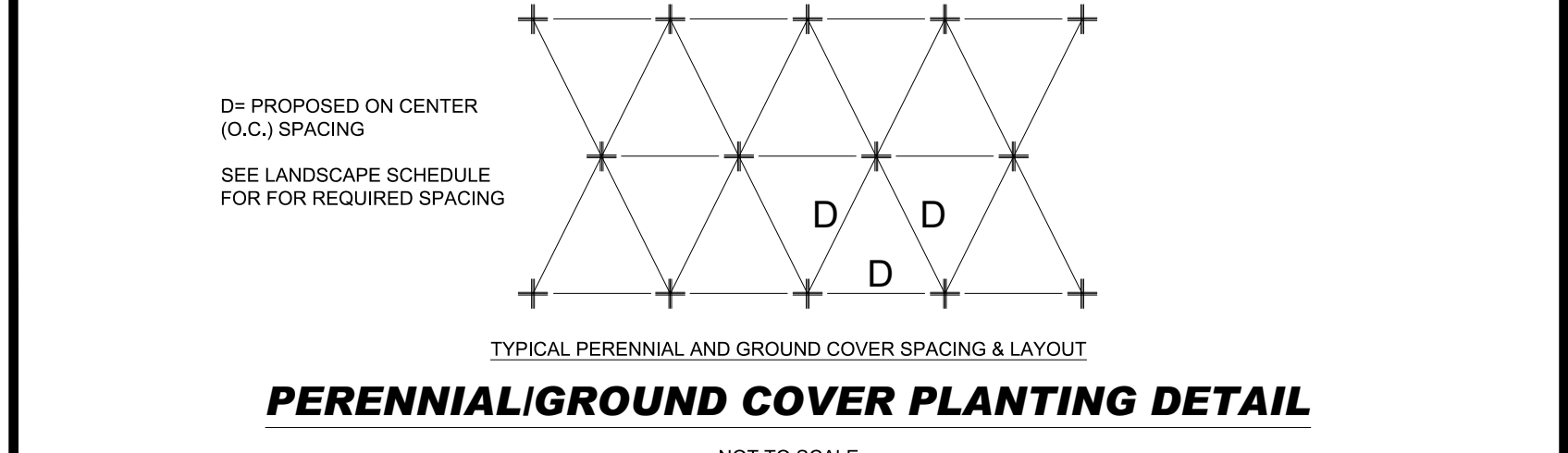

PERENNIAL/GROUND COVER PLANTING DETAIL
NOT TO SCALE

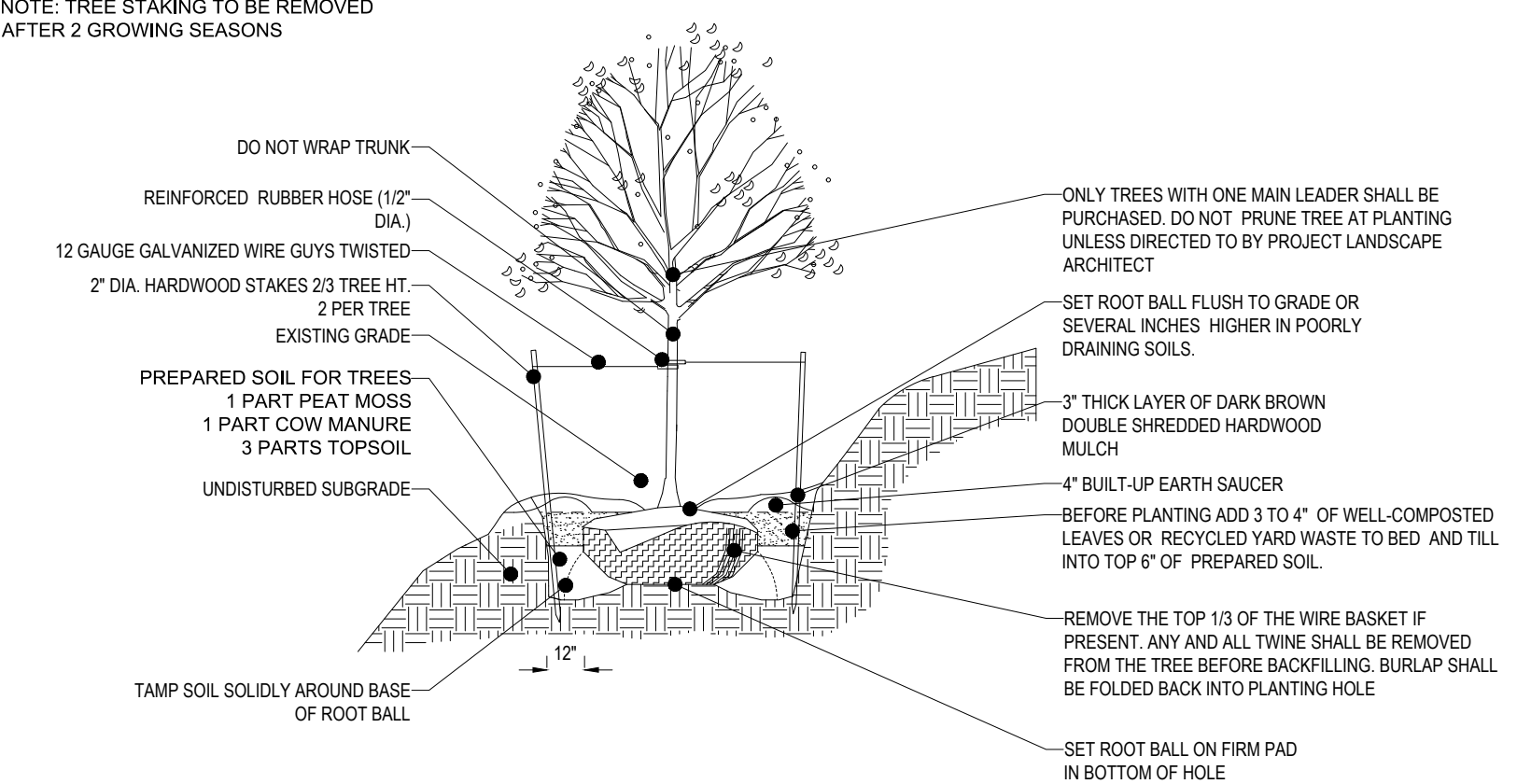

TREE PLANTING ON SLOPE DETAIL
NOT TO SCALE

SEEDING SPECIFICATIONS

- PRIOR TO SEEDING, AREA IS TO BE TOPSOILED, FINE GRADED, AND RAKED OF ALL DEBRIS LARGER THAN 2" DIAMETER.
- PRIOR TO SEEDING, CONSULT MANUFACTURER'S RECOMMENDATIONS AND INSTRUCTIONS.
- SEEDING RATES:

PERENNIAL RYEGRASS	1/2 LB/1,000 SQ FT
KENTUCKY BLUEGRASS	1 LB/1,000 SQ FT
RED FESCUE	1 1/2 LBS/1,000 SQ FT
SPREADING FESCUE	1 1/2 LBS/1,000 SQ FT
FERTILIZER (20-10-10)	14 LBS/1,000 SQ FT
MULCH	90 LBS/1,000 SQ FT
- GERMINATION RATES WILL VARY AS TO TIME OF YEAR FOR SOWING. CONTRACTOR TO IRRIGATE SEEDED AREA UNTIL AN ACCEPTABLE STAND OF COVER IS ESTABLISHED BY OWNER.

OWNER MAINTENANCE RESPONSIBILITIES

UPON OWNER'S (OR OWNER CONTRACTOR'S) COMPLETION OF LANDSCAPING WORK, THE OWNER IS FULLY RESPONSIBLE FOR ALL FUTURE MAINTENANCE, CARE, UPKEEP, WATERING, AND TRIMMING OF ALL INSTALLED VEGETATION, PLANTS, TREE, BUSHES, SHRUBS, GRASSES, GRASS, ORNAMENTAL PLANTS AND FLOWERS, FLOWERS, GROUND COVER, AND LANDSCAPING, INCLUDING ALL LANDSCAPE ISLANDS AND AREAS ADJACENT OR PART OF THE LANDSCAPED AREAS. THIS RESPONSIBILITY INCLUDES, BUT IS NOT LIMITED TO, THE FOLLOWING:

- TREES ADJACENT TO WALKWAYS AND AREAS OF PEDESTRIAN TRAFFIC MUST BE MAINTAINED TO ASSURE THAT ANY BRANCHES MUST BE LIMBED UP TO A CLEARANCE HEIGHT OF 7 FT. (FROM ALL PEDESTRIAN SURFACES) OR PRUNED BACK TO AVOID ANY INTERFERENCE WITH THE TYPICAL PATH OF TRAVEL.
- TREES WITHIN VEHICULAR SIGHT LINES, AS ILLUSTRATED ON THE LANDSCAPE PLAN, ARE TO BE TRIMMED TO A CLEARANCE HEIGHT OF 7 FT. (FROM ALL PAVED, TRAVELED SURFACES), OR AS OTHERWISE INDICATED ON THE PLANS.
- VEGETATIVE GROUND COVER, SHRUBS AND ORNAMENTAL PLANTS AND GRASSES MUST BE TRIMMED SO THAT NO PORTION OF THE PLANT EXCEEDS 30 INCHES ABOVE GRADE (OF ALL PAVED, TRAVELED SURFACES) ALONG AND WITHIN THE SIGHT LINES OF PARKING LOTS AND INGRESS-EGRESS WAYS.
- FALLEN PLANT FLOWERS, FRUIT, SEEDS AND DEBRIS DROPPINGS ARE TO BE REMOVED IMMEDIATELY FROM VEHICULAR AND PEDESTRIAN TRAFFIC AREAS TO PREVENT TRIPPING, SLIPPING OR ANY OTHER HAZARDS.

THESE REQUIREMENTS DO NOT AFFECT THE PLANT LIFE GUARANTEES THE LANDSCAPE CONTRACTOR IS REQUIRED TO PROVIDE.

STREET TREE AND PARKING LOT ISLAND PLANTING

STAKE AND GUY ONLY TREES IN VISIBLY EXPOSED AREAS.
REMOVE WIRES AFTER 4 MONTHS AFTER PLANTING.
DO NOT WRAP TRUNK WITH TAPE.
CONTRACTOR SHALL WATER AND MOISTEN SOIL DURING THE FIRST YEAR.
CONTRACTOR SHALL VERIFY THE PROTECTIVE SOIL CONDITIONS ARE FOUND TO BE UNDISTURBED AND ADEQUATE DRAINAGE IS REQUIRED.
DO NOT WRAP TRUNK WITH TAPE.
CONTRACTOR SHALL WATER AND MOISTEN SOIL DURING THE FIRST YEAR.
CONTRACTOR SHALL VERIFY THE PROTECTIVE SOIL CONDITIONS ARE FOUND TO BE UNDISTURBED AND ADEQUATE DRAINAGE IS REQUIRED.
DO NOT WRAP TRUNK WITH TAPE.

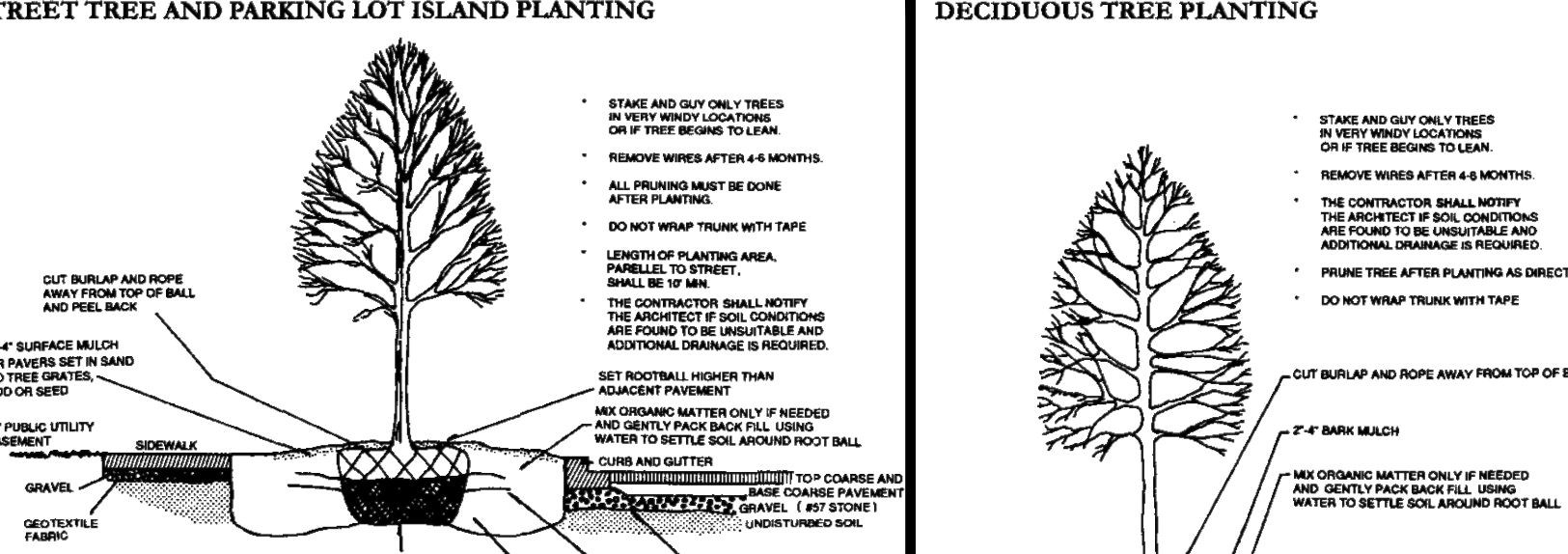

DECIDUOUS TREE PLANTING
NOT TO SCALE



TYPICAL UPRIGHT STAKING DETAIL
NOT TO SCALE

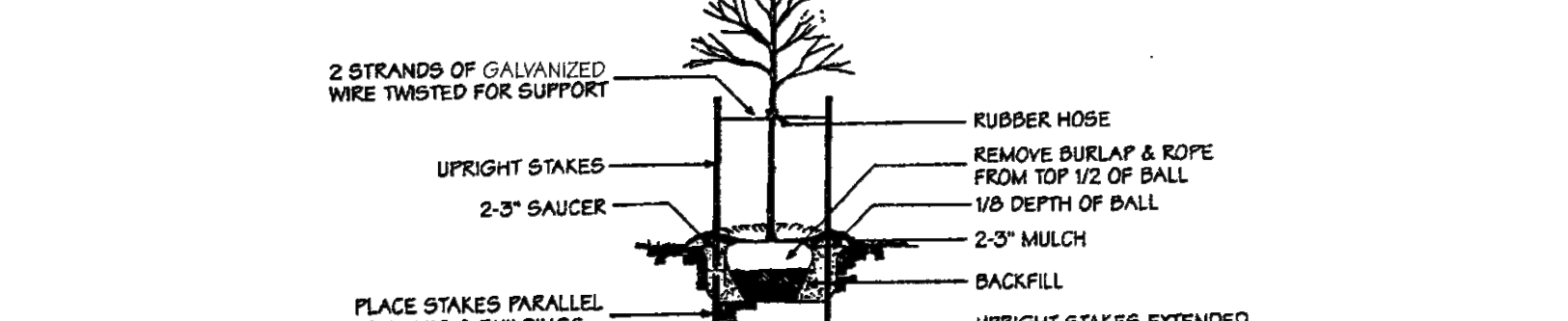

TYPICAL TREE GUYING DETAIL
NOT TO SCALE

Tree Size Height	Tree Size Caliper	Stake	#	Wire or Cable	Hoop
6-10'	1" to 1-1/2"	5-6' upright	2	14 gauge wire	1/2"
10-12'	2" to 2-1/2"	7-8' upright	2	14 gauge wire	1/2"
12-14'	2-1/2" to 3"	2" guy	3	12 gauge wire	1/2"
14-16'	3-4"	2" guy	3	12 gauge wire	3/4"

TYPICAL TREE GUYING DETAIL
NOT TO SCALE

BOHLER
SITE CIVIL AND CONSULTING ENGINEERING
PROGRAM MANAGEMENT
LANDSCAPE ARCHITECTURE
SUSTAINABLE DESIGN
PERMITTING SERVICES
TRANSPORTATION SERVICES

REVISIONS

REV	DATE	COMMENT	BY	CHKD BY
1	07/26/2024	REV. PER CITY COMMENTS	AD	RK
2	08/02/2024	REV. PER CITY COMMENTS	EO	RK
3	08/19/2024	PER CITY COMMENTS	RK	BK

811
Know what's below.
Call before you dig.
ALWAYS CALL 811
It's fast. It's free. It's the law.

NOT APPROVED FOR CONSTRUCTION
THIS DRAWING IS INTENDED FOR MUNICIPAL AND/OR AGENCY REVIEW AND APPROVAL. IT IS NOT INTENDED AS A CONSTRUCTION DOCUMENT UNLESS INDICATED OTHERWISE.
PROJECT No.: MDC230018.00
DRAWN BY: AD
CHECKED BY: BK
DATE: 03/19/24
CAD ID: LSCP - 1

FINAL SITE PLAN
FOR SHEETZ WALNUT HILL

LOCATION OF SITE
16529 S FREDERICK AVENUE
MONTGOMERY COUNTY
GAITHERSBURG, MD 20877
TM: FS63, PARCEL: B, BLOCK: A
SUBDIVISION: SECTION ONE
WALNUT HILL

BOHLER
9711 WASHINGTONIAN BLVD, SUITE 375
GAITHERSBURG, MARYLAND 20878
Phone: (301) 809-4500
Fax: (301) 809-4501
MD@BohlerEng.com
D.H. PARK
9/5/2024
REGISTERED LANDSCAPE ARCHITECT
D.H. PARK, HEREBY CERTIFIES THESE DOCUMENTS WERE PREPARED AND APPROVED BY ME, AND THAT I AM A LICENSED LANDSCAPE ARCHITECT UNDER THE LAWS AND REGULATIONS OF MARYLAND, LICENSE NO. 3894, EXPIRATION DATE: 04-22-28

SHEET TITLE: **LANDSCAPE NOTES AND DETAILS**
SHEET NUMBER: **L-102**